

Vinyl Application Instructions

McNamara Signs prides itself on offering the highest quality products and services at competitive prices. We strongly recommend following all guidelines outlined in this form to insure that your graphics will adhere properly to surface.

GUIDELINES

I. Surface Preparation

All surfaces must be considered dirty and must be cleaned prior to the application of the vinyl. Recommended procedures for specific surfaces are listed below.

A. PLASTICS & GLASS

Saturate a clean cloth with a 2 to 1 mixture of water and isopropyl alcohol and wipe surface with a dry lint free cloth. (Windex may be used if no isopropyl alcohol is available.)

B. PAINTED METALS AND BASE METALS

These surfaces must be cleaned with with a solvent such as E.I. Dupont Prep-Sol Cleaning Solvent 39195, Xylol, VM&P Naphtha, or Lacquer Thinner. Dry the surface with a lint free cloth before the solvent evaporates. (Freshly painted surfaces must be dried one week prior to application.)

C. INTERIOR PAINTED SURFACES

Paint must be dried one week prior to application of vinyl. Clean the area where the graphics are to be applied with a household cleaner such as 409. Rinse thoroughly and dry with lint free cloth

II. Temperature Requirements

Air and application surface must be above 55 degrees Fahrenheit for secure bond to form. (A heat gun or hair drier may help raise the temperature to these requirements.)

III. Application Instructions

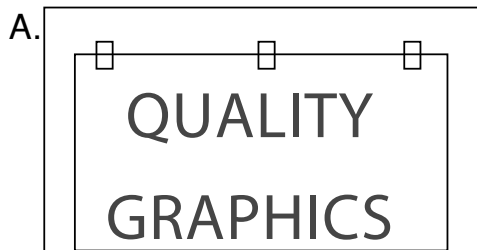

A. Use 1"-2" strips of masking tape to position graphics in the area you wish to apply them to.

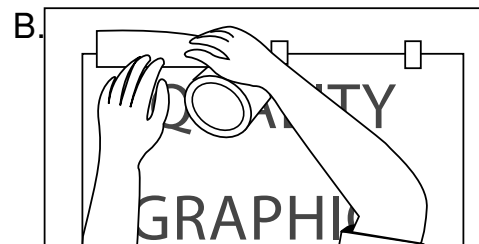

B. Apply horizontal tape hinge at the top of vinyl graphics.

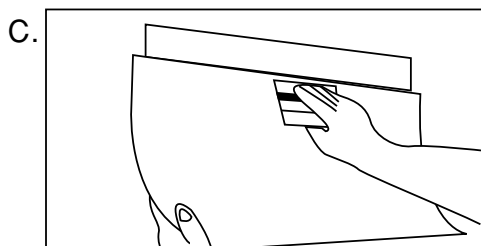

C. Remove transfer tape entirely and let the graphics drape, lightly holding the graphics away from the surface as to not let them fall onto surface area. Begin squeegeeing firmly from the top center, in down and outward motions over the entire graphic.

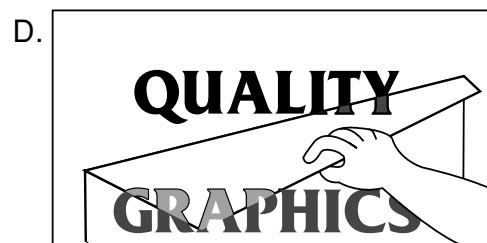

D. Remove transfer tape at an 180 angle. (pull back on itself)

E. Resqueegee entire graphic with lint free cloth over the squeegee.